

# 108 Parshvanath Jinalay London



**JAIN CENTRE LONDON**  
64-68 Colindale Avenue, London NW9 5DR

## The Vision and Mission

The Jain Network is a registered charity in England and Wales. It aims to develop the Jain Community, its infrastructure for the spiritual and physical needs (including a place of worship and study for all Jains), and awareness of Jainism in the wider community. Its mission is to improve the spiritual and physical quality of life for Jain and wider community.

## Aims and Objectives of Jain Network

- Developing the Jain Centre London, a place of worship for all major Jain traditions and community facilities
- Improving quality of life of Jain and wider community
- Promoting Jain interests to the local and central government and other institutions of influence
- Advancing interfaith and community cohesion activities
- Promoting personal well-being and social inclusion activities for Jain and wider community
- Creating a social enterprise and cultural hub to provide opportunities and facilities for education and training

## Development to date

The Jain Network acquired a substantial freehold site at 64-68 Colindale Avenue, London, NW9 5DR in May 2010. Planning permission for the change of use from an industrial site to a place of worship and community centre was granted in October 2010. The premises had an interim development - providing the Jain temple, auditorium, seminar rooms, educational wing, administrative infrastructure and community facilities. In January 2013, further planning permission was obtained to demolish the present building and to construct a 3 floor Jain Centre with temple, community centre and 3 flats.

# Need For Jain Centre In London

London is considered as premier world capital for business, culture, innovation and finance. The British Government, Media, Statutory and other Institutions in the United Kingdom engage with the nine major world faiths including Jainism. As a result, on major national and international events such as the Royal Wedding, Commonwealth Services and Olympics, Jain representatives are being invited.

To bring greater awareness of Jainism, its practices and values to the wider public in UK and to serve the local and visiting Jains, a traditional architecturally magnificent Jain Centre is needed in London. This centre will be a place of worship and study for all Jain traditions and a hub for community activities.

Jains in United Kingdom are a vibrant community of more than 25,000 followers. They created the first Jain Centre in the world in Leicester to serve all major Jain traditions. It has become a place of pilgrimage for the Jains and tourist attraction for the City of Leicester. At its installation ceremony (pratistha) in 1988, about 2000 devotees came from India and other countries in addition to thousands from all over UK.



**Depiction of Jain Treasure Kalpasutra to  
HM The Queen and Archbishop**



**Dance at Mahavir Janma Kalyanak  
Celebration**



**Devotees performing Snatra Puja**

# Present Activities and Future Development



Interim Temple



An event in the Auditorium

## Jain Network's present activities

- Religious activities such as daily Puja, Aarti, Snatrapuja and Pathshala for children and adults on Sunday.
- Facilities for Samayik, Pratikraman, celebration of events on sacred days such as Paryushan, Diwali and both Aso and Chaitri Ayambil Olis.
- Interfaith events, workshops and seminars
- A social enterprise for education, cultural, health, social action and well-being for Jain and wider community to support the maintenance of the Centre.

## Future development

The Jain Network is planning to demolish the current building and start the work to construct a purpose built Jain Centre in January 2016, expected to be completed by 2018. The ground and first floor will be a community centre; the second floor will house traditional white marble temples and places of worship for all major Jain traditions and Aum & Hrim shaped 108 Parshvanath Jinalay. The first floor will also have a multifaith room and library. The Svetambar Temple will have: Central image Parshvanath; Others : Munisuvrat and Mahavir Swami. The Digambar Temple will have: Central image Rishabhdev; Others : Nemnath, Simandhar Swami, Bahubali and Bharat Chakravarti. The temple will also have Guardian deities including Padamavati, Manibhadra, Nakoda Bhairav, Ghantakarna Mahavir, Saraswati and Lakshmiji. Places of worship will include Guru Mandir, Sthanakvasi / Terapanthi Upashray and Shrimad Rajchandra Gyan mandir.

It aims to provide sustainable community services such as advocacy, educational, environmental, employment, health, social, travel, spiritual, civic and cultural services, youth and women empowerment and to work with Voluntary Community Organisations, Social Enterprises and Charities.

# Proposed Plans For The Centre

## Ground Floor Plan:

- Drop in area for 2 cars
- Foyer
- Entrance hall
- Reception area
- Cloak room
- Offices
- Kitchen
- Dining area
- Parking for 14 cars
- Cycle stand
- Two staircases
- Two lifts and other utilities

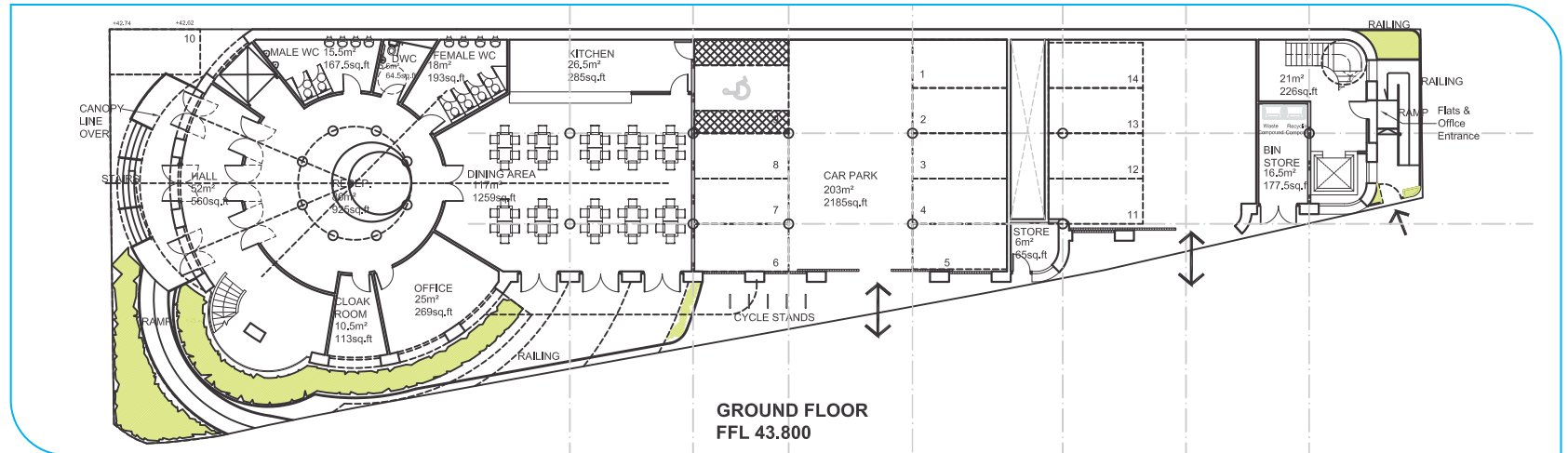

## First Floor Plan:

- Reception area
- Library/Multifaith room
- Meeting room/Office
- Conference rooms
- Male & female showers
- Kesar Sukhad room
- Display lobby
- One flat
- Other utilities

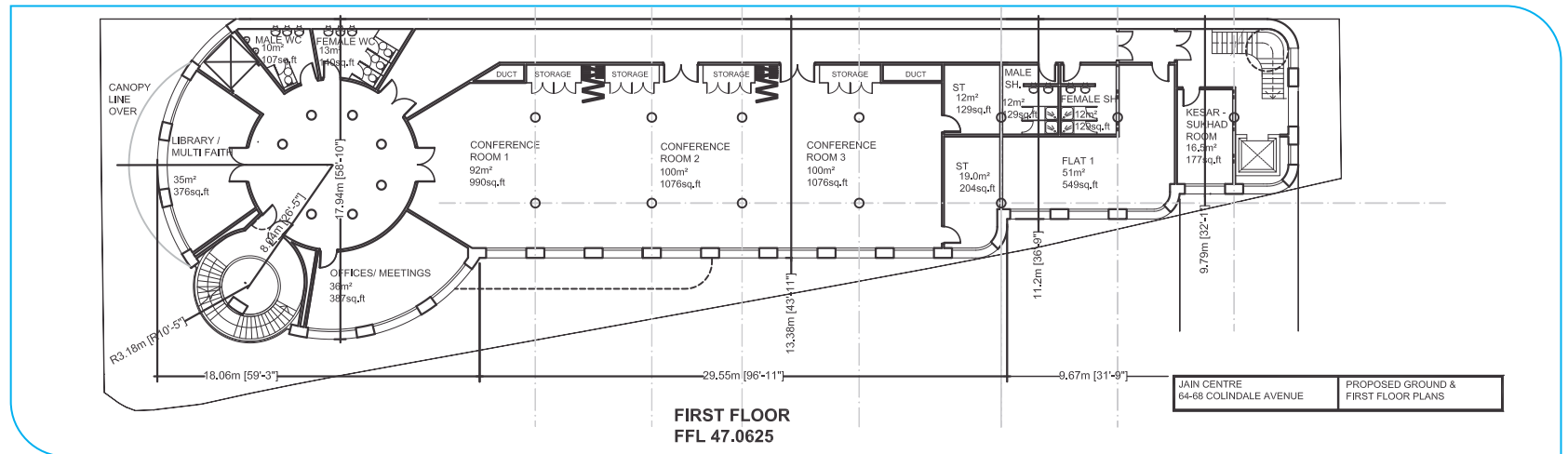

# Proposed Plans For The Centre

## Second Floor Plan:

- Reception
- Svetambar temple
- Digambar temple (D)
- 108 Parshvanath Jinalay
- Sacred hall
- Guru Mandir
- Sthanakvasi/Terapanthi Upashray
- Shrimad Rajchandra Gyan Mandir
- Guardian Deities
- Display lobby
- Two flats

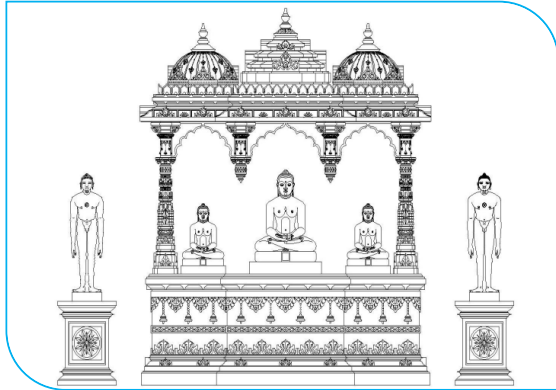
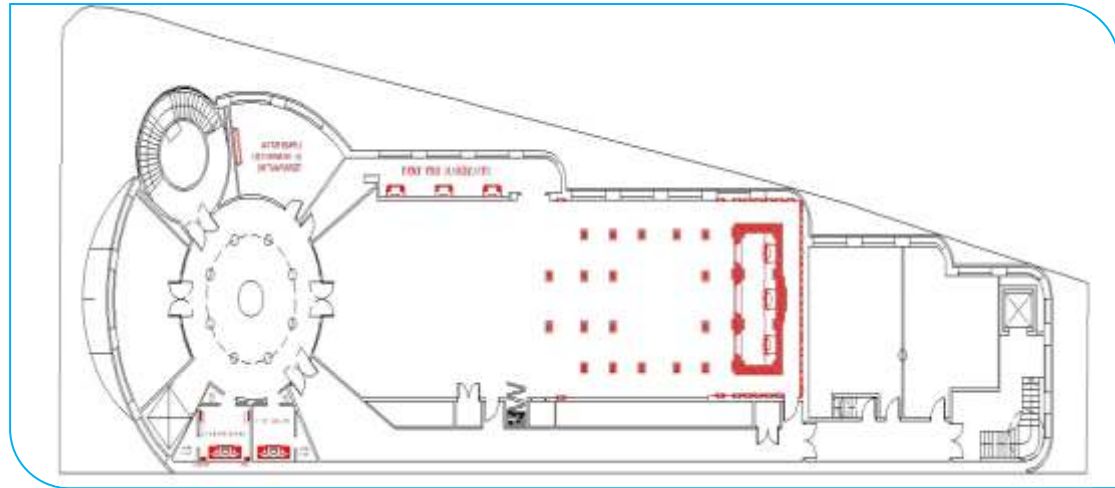

Proposed Digambar Temple

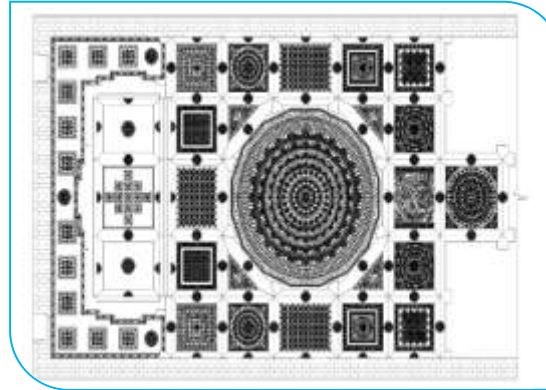

Ceiling Plan

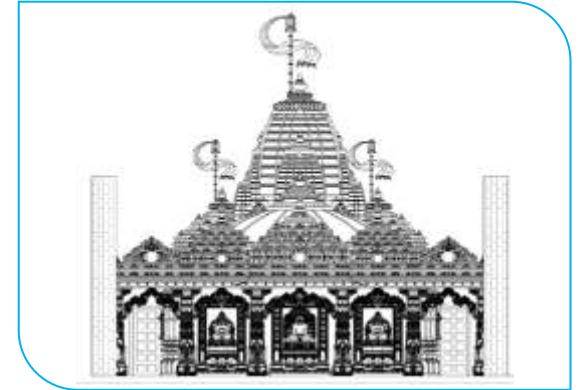

Proposed Svetambar Temple

## **Hum and Hrim shaped 108 Parshvanath Jinalay**

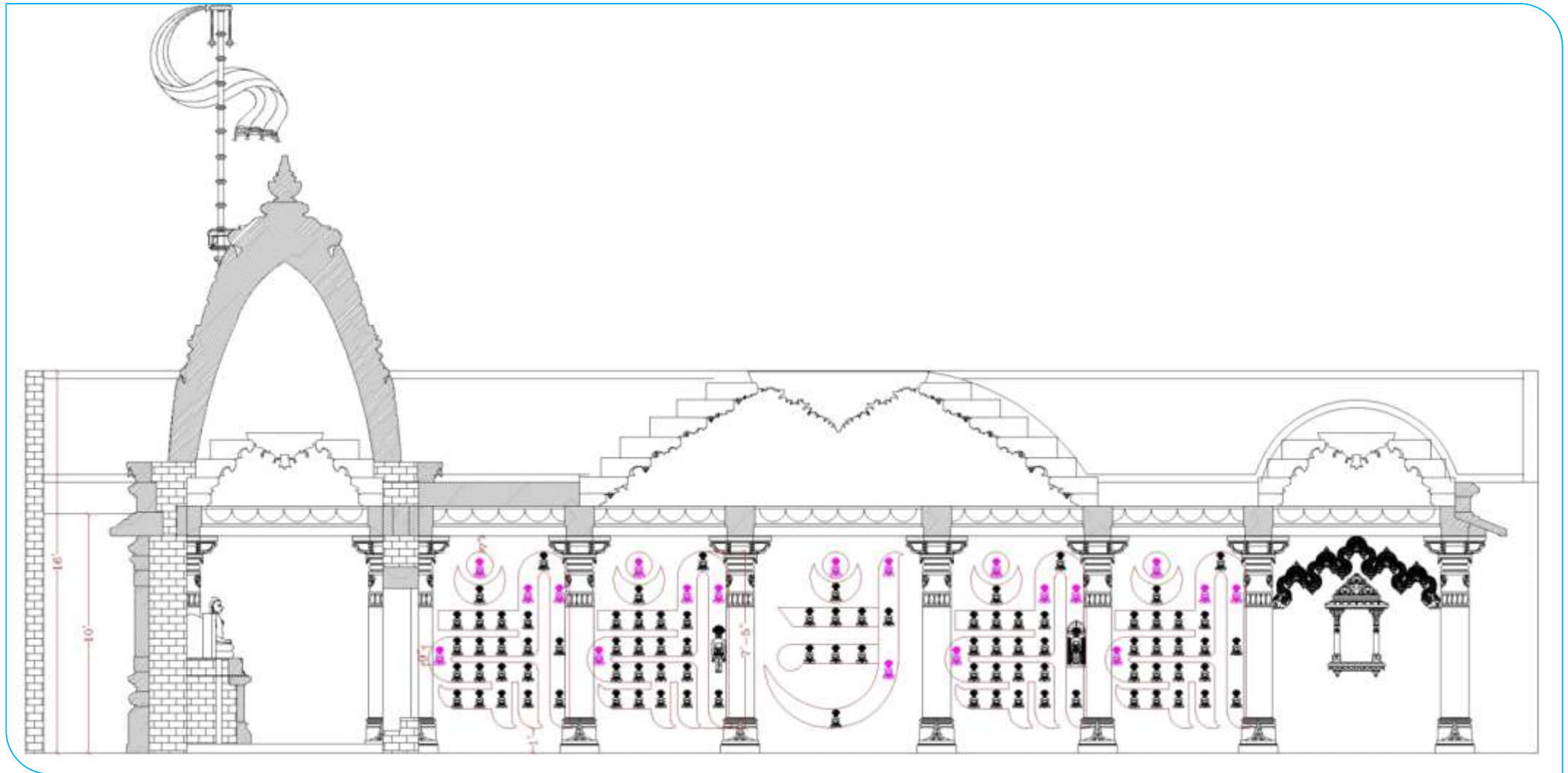

**Unique feature for worship in the temple for the devotees**

# Guru Gautam Murti, Guardian Deities And Embossing Of Jain Symbols On Glass



Guru Gautam

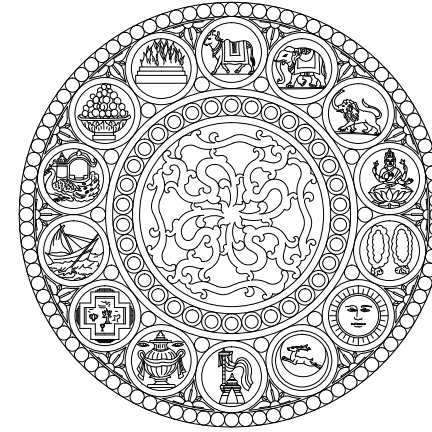

Embossing on glass windows

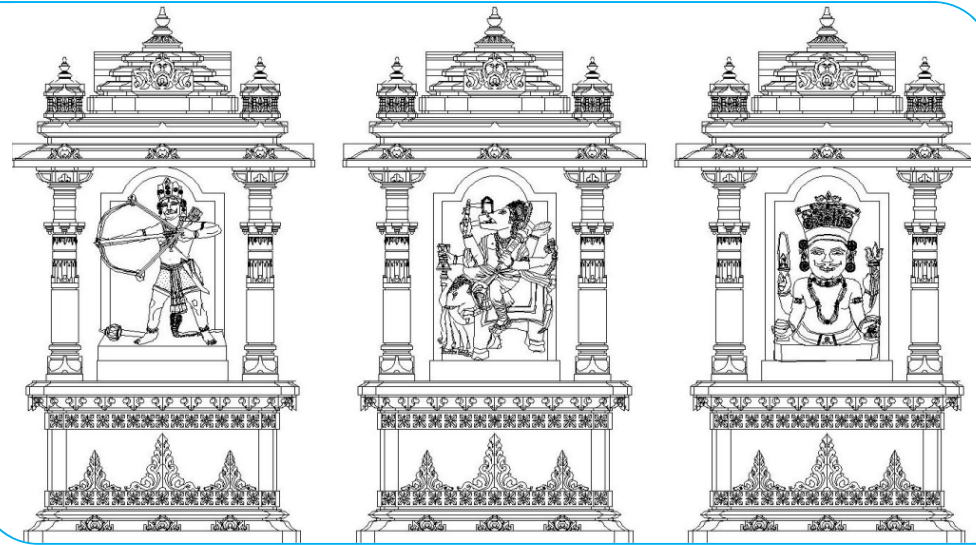

Ghantakarna Mahavir

Manibhadra Veer

Nakoda Bhairav

# Unique Feature of the Jain Centre

*Place of worship and study for all major Jain traditions, Aum and Hrim shaped 108 Parshvanath Jinalay, multifaith centre & community centre .*

- Situated in Barnet, North West London, the Jain Centre is ideally located amidst the major Jain population residing in the Boroughs of Barnet, Brent and Harrow. It is within easy reach from central London and from outside as it is well connected by major roads and public transport. Therefore its location makes it a hub of Jain and community activities.
- The Jain Network's constitution allows appointment of Overseas trustees, making the London Jain Centre an international place belonging to all. It will be a place for worship, study and pilgrimage for all Jains; a learning centre for Jainism, its values and practices; a resource centre for educational institutions, interfaith activities and guests; and a community centre for the local Jains. The funds of the Jain Centre are managed as per the laid down principles in the Jain tradition such as temple fund (Dev Dravya), general fund (Sadharan) etc. The devotional and spiritual practices, the Jain way of life, including compassion (Anukampa) and animal welfare (Jivdaya), Jain studies and improvement of quality of life of the people, are the core purposes for the establishment of the Jain Network.
- One of its constituents, the Ahimsa for Quality of Life (AQL), has supported the projects for relief of poverty in Pavapuri (Bihar) and Samet Shikhar (Jharkhand) and for the disabled and mentally retarded children in Mumbai and Jaipur. Its other constituent, the Jain Academy (JA), has sponsored a course on Jainism at De Montfort University, Leicester for 3 years; has established the Chair for the Jain Academic and Research Centre in Mumbai University; has initiated the course in Jain Studies at the School of Oriental and African Studies (SOAS) London University and supported it for 2 years; and has established the Department of Jain Studies in Faculty of Comparative Religions in Antwerp, Belgium.
- In the fully developed Jain Centre, the Jain Network plans to provide courses in Jain Studies in subjects such as Jain philosophy, Jain history, Jain literature, Jain sociology, Gujarati, Hindi and Prakrit language, Applied Jainology (meditation, yoga , therapeutics, Jain way of life, Jain food and stress management), non-violence and peace; environmental concerns and care of all life, training for religious workers, Minister of Religion and cultural literacy for health, educational, social workers and political leaders.

# How You Can Participate In Development Of 108 Parshvanath Jinalay

Please help in the development of the Jain Centre:

By joining as:

- Chief Patron: donation £25,000
- Patron: donation £10,000
- Life member: donation £1,000
- Member: £10 per month or £100 per annum via standing order

Or by donations:

- Donations for building, putting plaques on halls, pillars and rooms
- Donating in temple fund
- Donations for resources and sponsorship for staff members
- Donations for one brick or multiple (per brick £101)

Volunteering for different activities

**The management of the funds is done in accordance with the Jain traditions**

Please send your donations to the Jain Centre, 64-68 Colindale Avenue, London NW9 5DR

*Promoting Jain values and creating Jain awareness in wider community*

The Jain Network supports other organisations and forums by allowing the use of its office facilities; currently this includes Art of Living, Council of Dharmic Faiths, Barnet Hindu Forum, JNHA Social Enterprise and many other activities such as yoga, meditation and community welfare activities for all ages.



Model of Jain Centre

### Contact Details:

Jain Centre, 64-68 Colindale Avenue, London NW9 5DR

Tel: 020 8200 0828

Email: [info@jainnetwork.com](mailto:info@jainnetwork.com)

Website: [www.jainnetwork.com](http://www.jainnetwork.com)

### Ahmedabad

Rakesh Shah +98254 40044

Kalpesh Shah +98982 80077

### Mumbai

Dr Bipin Doshi +98210 52413

Mayank Shah +98210 94665

### London

Dr Natubhai Shah +44 78875 62286

Alpa Kothari +44 77137 63223



### **How to find us**

#### **By public transport:**

**Train:** The nearest underground station is Colindale on the Edgware Branch of the Northern Line.

**Bus:** Buses 303 and 204 stop just opposite the Centre at Stonecrop Close (stop name). Buses 32 and 142 stop at Colindale Avenue from where it is about 3 to 4 minutes walk. Bus 324 stops at Colindeep Lane from where it is just 2 minutes walk.

#### **Car Parking:**

There is plenty of off-street parking near the Centre and we have made arrangements for 100 parking spaces at the Colindale retail park opposite Colindeep Lane traffic lights.

## Back Of Inner Shrine (gabhara) Svetambar Temple

